

Stainless Steel Instant-On® Sensor

Liquid Level Detection and Overfill Protection for the Chemical Industry

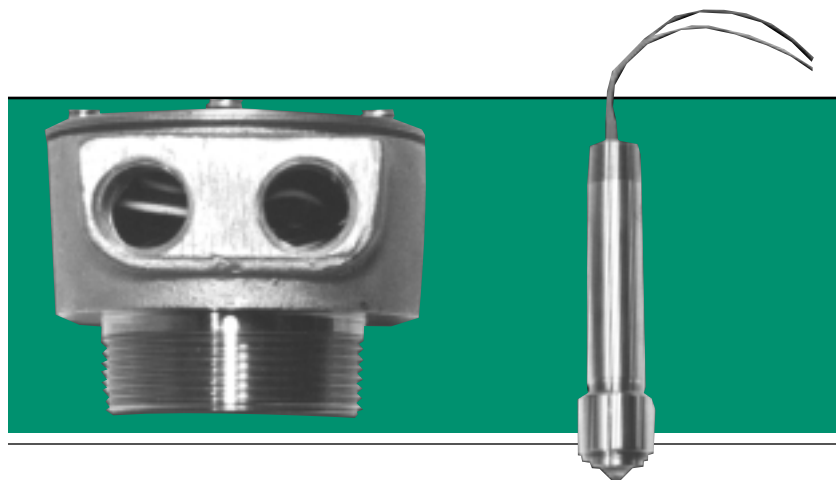

SP-MHC (SS) Holder

SP-TO (SS) Sensor

Scully Stainless Steel Instant-On® Sensors are part of an automatic and continuous self-checking system you can count on. Scully Optic Sensors offer these advantages:

- Maximum safety with Dynacheck® - automatic and continuous self-checking circuitry - when used with Scully Rack Controls.
- Versatile point liquid level sensing in storage tanks, tank trucks and other applications.
- AISI 316 stainless steel construction used to resist corrosion.
- Functions within a wide range of ambient temperatures in a variety of liquid chemicals.
- Unequaled resistance to fogging.
- Dependable solid state construction.
- Replaceable Prism

Description

The Stainless Steel Instant-On Sensor is designed for liquid chemical overfill prevention and point level detection. It is used in storage tanks, tank trucks and other vessels during loading operations. The Instant-On Sensor uses optic sensing technology and is compatible with thermistor style control monitors.

This sensor is compatible with the ST-15 and Biclops® Rack Control Monitors, offering the safest systems available for overfill prevention.

In tank farms, multiple storage tanks are protected

by using a Scully ST-15-WX, ST-12 control monitors to provide individual alarm and relay outputs for each sensing point. Compatible control monitor data sheets are listed on back.

Safety

The stainless steel Instant-On sensor incorporates Scully's unique and exclusive Dynacheck® circuitry when connected to Scully monitoring equipment. Using pulsed signals which simulate a wet or "unsafe" condition, the monitor automatically and continuously checks the entire system operation; controller, wiring, connectors and sensors, for faults 30 times per second. If liquid comes in contact with the sensor, or in the event a fault occurs, the pulsed signals cease and the monitor signals for immediate shutdown of the loading operation. No operator involvement is needed!

Sensor Holder

The Scully SP-MHC(SS) sensor holder is designed for mounting in a 2" NPT tapping. This allows for convenient mounting in both storage tanks and tank truck vehicles.

The fixed-length stainless steel sensor threads into the holder. It may be extended using the appropriate length of 3/4" stainless steel pipe and a coupling. Consult Scully for assistance.

Setting New Standards In Safety

All Dimensions In Inches

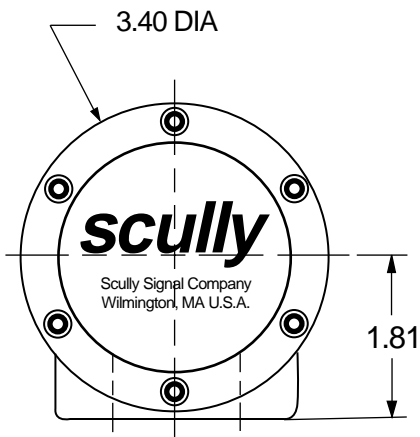

SP-MHC(SS) Holder
Top View

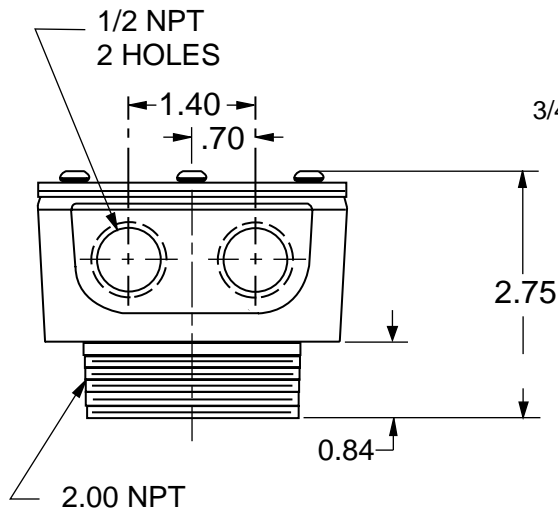

SP-MHC(SS) Holder
Side View

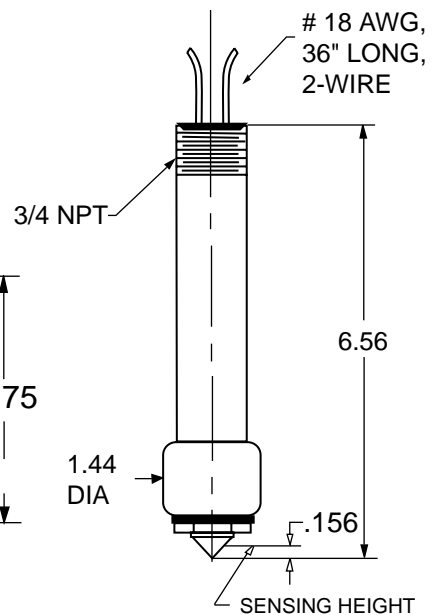

SP-TO(SS) Sensor
Side View & Sensing Level

Technical Specifications

Temperature Range:	-40° to +140° F (-40° to +60° C).	Exposed Materials:	316 Stainless steel, Pyrex glass, teflon seal.
Product Range:	Group D hazardous materials and non-hazardous materials which are compatible with optic sensing technology. Consult the factory with specific questions.	Level Repeatability:	+/- 1/16"
Detection Level:	Fixed, refer to diagram. The sensor may be adjusted to any length using 3/4" stainless steel pipe and a coupling. Detection level should be set slightly above each compartment's maximum capacity level weights and measures marker.	Electrical Leads:	Five color coded, 36" Teflon covered long leads.
		Size:	Refer to diagram.
		Weight:	Sensor; 15.5 oz. (.45 kg.) Holder; 2.8 lbs. (1.27 kg.)
		Compatible Control Monitors:	ST-15, ST-15 WX, ST-12 Biclops, Thermistor/Optic, Intellitrol

Scully Stainless Steel Optic Sensors are approved for use in Class I, Division 1, Group D hazardous locations by factory Mutual research and the Canadian Standards Association as part of an intrinsically safe system.

Ordering Information

Description	Part #
SP-TO(SS) Stainless steel Instant-On® sensor only	08583
SP-MHC(SS) holder assembly with 3/4" NPT thread, no sensor	08585
Replacement sensor holder cap	31605
Replacement sensor holder gasket	31606

Biclops, Dynacheck, Dynamic Self-Checking, Dynamic Self-Test, Faylsafe, Intellicheck, Intellitrol, Intelliview, Load Anywhere, Maxsafety, MulteCept, Scully, Scultrol, Scul-Lock, Scul-Tel, Scul-Tite, TABS and V.I.P. are registered trademarks of the Scully Signal Company. Specifications are subject to change without notice.

Worldwide Contact
Scully Signal Company
70 Industrial Way
Wilmington, MA 01887 USA
Tel: 1-800-272-8559 or (617) 692-8600
Fax: (617) 692-8620
email: sales@scully.com
www.scully.com

